

# Solar Star Thermal Switch Installation Instructions

**OVERVIEW** The Solar Star Thermal Switch will turn off the Solar Star when the temperature in the attic is below 65° F (18° C) and will turn on the Solar Star when the temperature in the attic is greater than 85° F (29°C).

**Note:** The Thermal Switch should be installed prior to roof installation.

**Step 1.** Remove the fan blade from underside of roof mount vent. Pull straight up on fan hub until fan blade is free from the motor shaft. **(Diagram A)**

**Step 2.** Disconnect one lead wire from motor terminal **(Diagram B)**. Add Thermal Switch to disconnected lead wire. **(Diagram C)**

**Step 3.** Align notch in fan hub with motor shaft and replace fan blade. **(Diagram D)**

**Return to the Solar Star Installation Instructions to complete installation.**

Please read all warnings and instructions before beginning installation.

## ADDENDUM TO PARTS LIST

1. Thermal Switch (Optional, Sold Separately) (1)

Diagram A

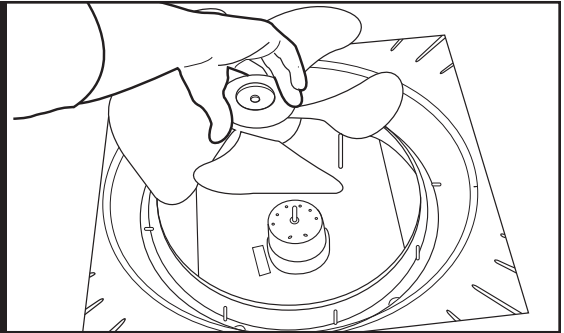

Diagram B

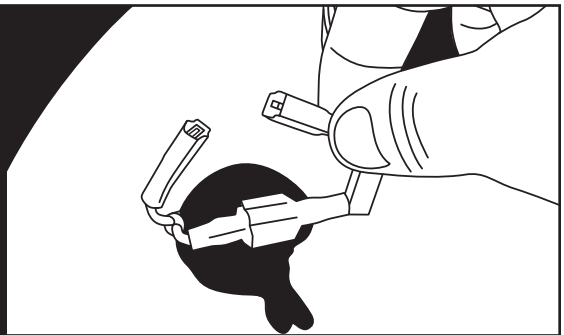

Diagram C

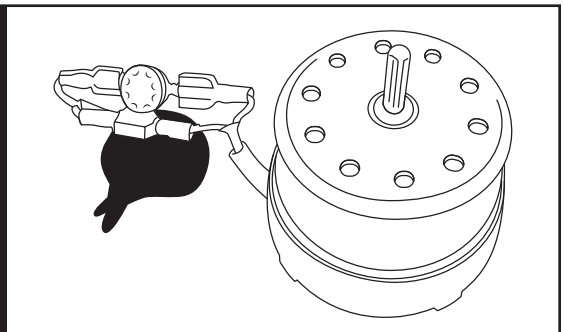

Diagram D

